

Heater Core Replacement

Replacement

1. Turn off the engine, apply the parking brakes, and chock the tires.
 2. Disconnect the batteries.
 3. Drain the coolant from the cooling system. For instructions, see [Section 20.01](#), Subject 100.
 4. Remove the dash panels listed below. See [Fig. 1](#). For instructions, see [Section 60.08](#).
 - electrical cover
 - upper dash cover
 - heater and air conditioner cover
 - waste bin
 - console cover
 - dash trim cap
 - upper dash assembly, center panel
 5. Remove the tie straps on the wiring harness as needed to access the heater core.
 6. Remove the capscrew that attaches the right side of the shield to the HVAC assembly. Move the shield to access the heater core. See [Fig. 2](#).
 7. Remove the capscrews that attach the lower duct to the HVAC assembly and remove the lower duct.
 8. Remove the capscrews that attach the heater core service cover to the HVAC assembly and remove the service cover. See [Fig. 3](#).
 9. Remove the air cleaner. For instructions, see [Section 09.01](#).
 10. Remove the hose clamps that attach the heater hoses to the heater core tubes. Remove the heater hoses.
 11. Remove the heater core retaining plate. See [Fig. 4](#).
 - 11.1 Remove the capscrew that attaches the heater core retaining plate to the frontwall.
 - 11.2 Remove and set aside the no-drip tape from around the heater core tubes.
 - 11.3 Pull on the tab to remove the retaining plate.
 12. From inside the cab, remove the heater core.
 13. Install a new heater core in the HVAC assembly. Push the heater core into the HVAC assembly until the heater core makes contact with the far side of the HVAC assembly.
 14. Using a capscrew, attach the heater core retaining plate to the frontwall.
 15. Install the no-drip tape around the heater core tubes at the retaining plate.
 16. Using hose clamps, attach the heater hoses to the heater core tubes.
- NOTE:** Make sure that the string seal is in the groove on the lower portion of the heater core service cover before installing the service cover.
17. Using capscrews, install the heater core service cover on the HVAC assembly.
 18. Using capscrews, attach the lower duct to the HVAC assembly.
 19. Using a capscrew, attach the shield to the HVAC assembly.
 20. If needed, use tie straps to bundle the wiring harnesses.
 21. Install the dash panels listed below. For instructions, see [Section 60.08](#).
 - upper dash assembly, center panel
 - dash trim cap
 - console cover
 - waste bin
 - heater and air conditioner cover
 - upper dash cover
 - electrical cover
 22. Install the air cleaner. For instructions, see [Section 09.01](#).
 23. Fill the cooling system with coolant. For instructions, see [Section 20.01](#), Subject 100.
 24. Connect the batteries.
 25. Remove the chocks from the tires.

Heater Core Replacement

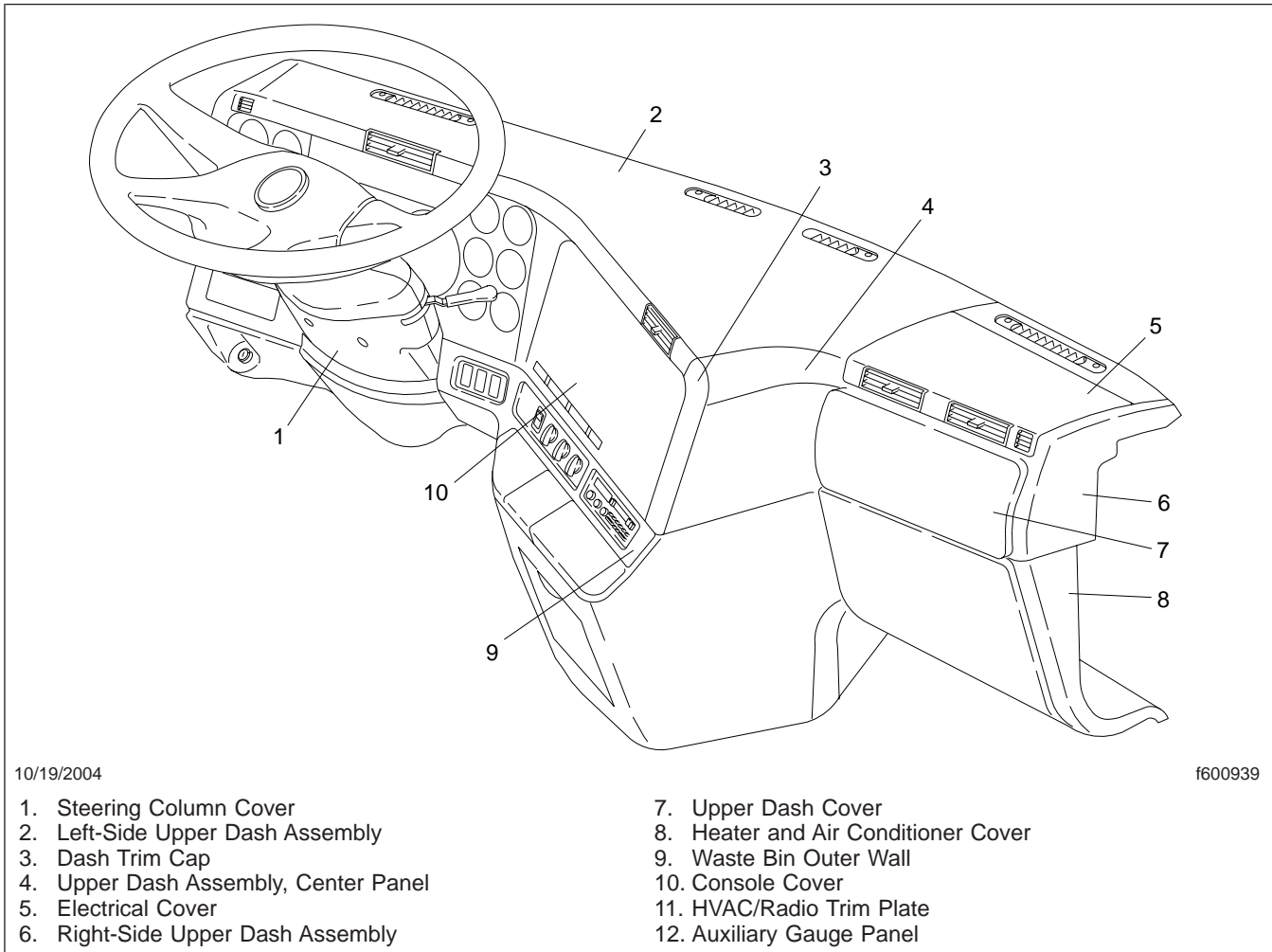

Fig. 1, Century Class Conventional Dash Panels

Heater Core Replacement

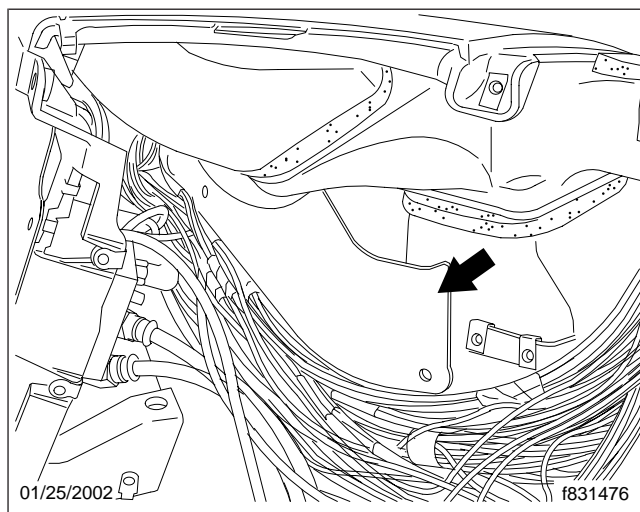

Fig. 2, Shield

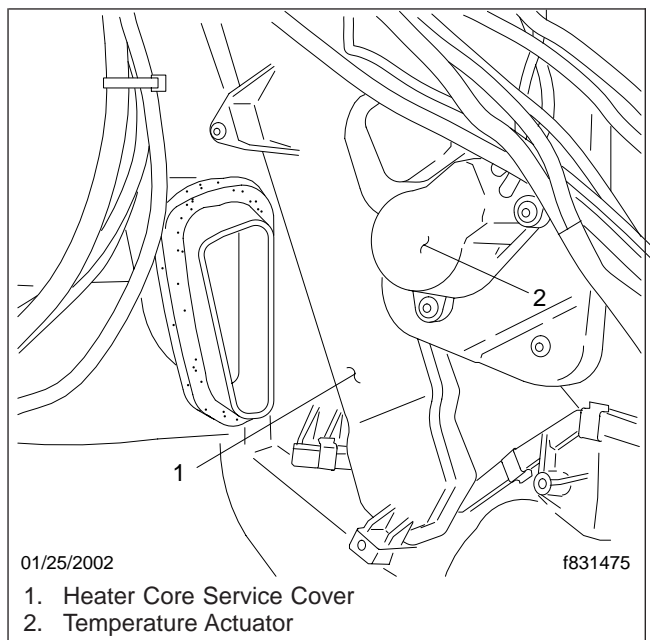

Fig. 3, Heater Core Service Cover

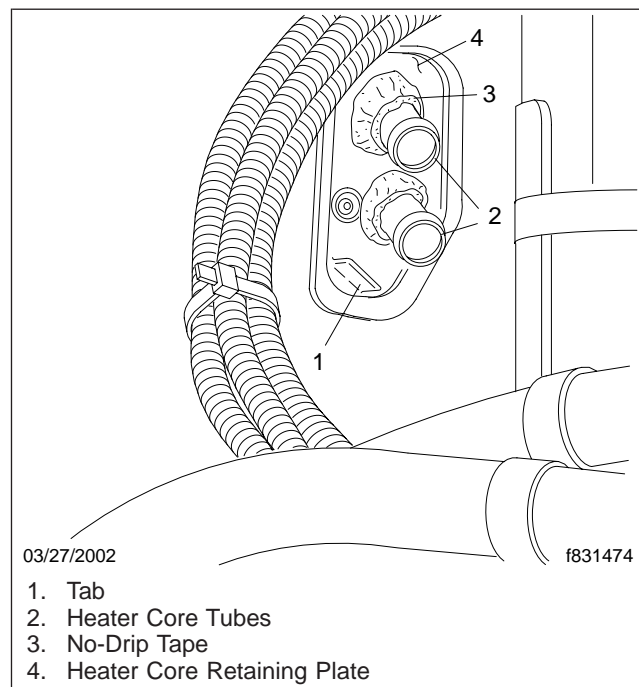

Fig. 4, Heater Core Retaining Plate